

1K



## Exhaust Control System Description

The EXCS consists of the EXCV, EXCVA and EXCV cables.

EXCV is installed in the exhaust pipe. EXCVA is mounted inside of the right frame. The EXCV is operated by the EXCVA via the cables. This system is designed to improve the engine torque at low engine rpm.

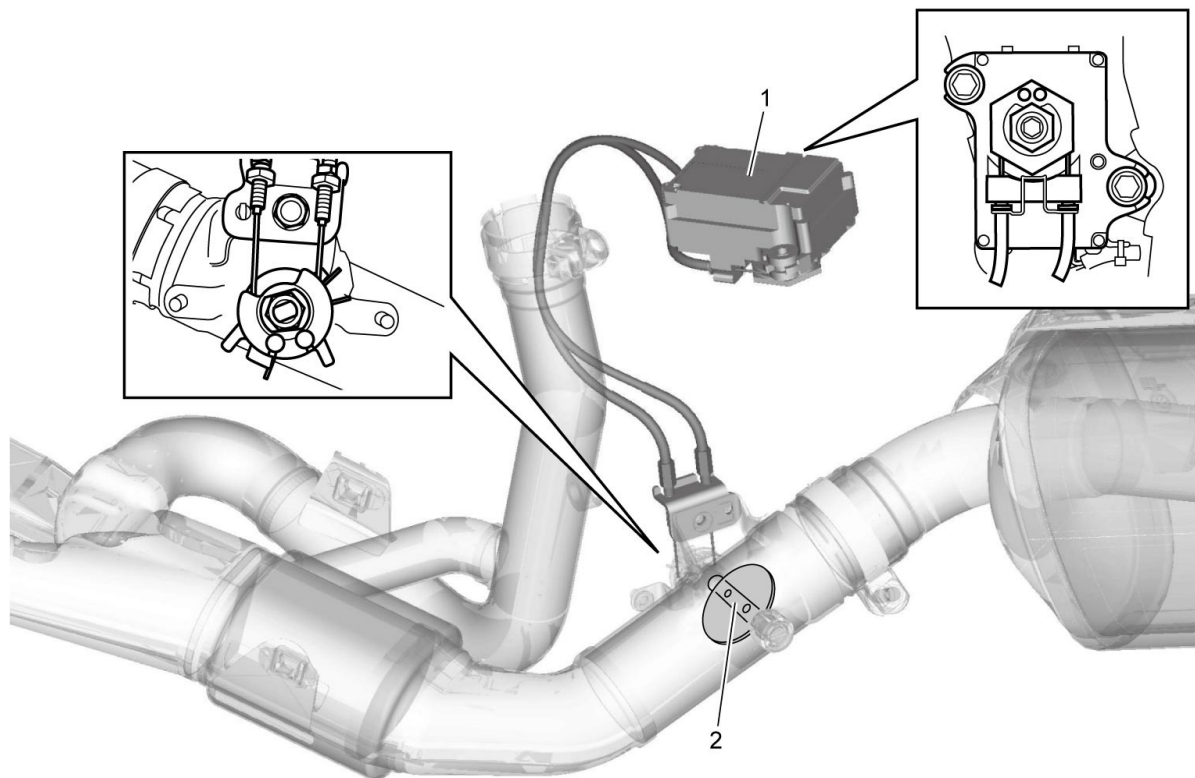

1.	Exhaust control valve actuator (EXCVA)	2.	Exhaust control valve (EXCV)
----	--	----	------------------------------